

C PNM 2004

PNM
2401 Aztec NE
Albuquerque, NM 87107
Fax 505 855-6320
www.pnm.com

July 19, 2004

CERTIFIED MAIL
RETURN RECEIPT REQUESTED

Carolyn Cooper
New Mexico Environment Department
Hazardous Waste Bureau
Permits Management Program
2905 Rodeo Park Drive East, Building 1
Santa Fe, NM 87505-6303



*A personal commitment
to New Mexico*

**RE: Person Generating Station (NMT 360010342-1) – Supplemental Information for
Groundwater Monitoring Data Annual Report for 2003**

Dear Ms. Cooper:

Public Service Company of New Mexico (PNM) has received your letter request for supplemental information dated July 7, 2004.

Enclosed are five groundwater contamination plume maps. The three April 1993 plume maps are the earliest plume maps currently available and show the estimated extent of the groundwater plume at that time (the groundwater treatment system became operational in January 1995). Also enclosed are the most current groundwater contamination plume maps (April 2004). No current plume map for 1,1,1-TCA has been prepared since the concentrations of this contaminant have dropped to near or below laboratory detection limits in the monitoring wells.

Regarding your request to revise Table 3 to include the 2003 water level measurements, please note that the water level measurements for all monitoring wells can be found on the Well Sampling Data Forms in Appendix D of the 2003 annual data report.

Please note that my mail stop is now MS Z110. If you have any questions, please contact me at (505) 855-6392.

Sincerely,

John Hale, P.E.
Technical Project Manager

Enclosures

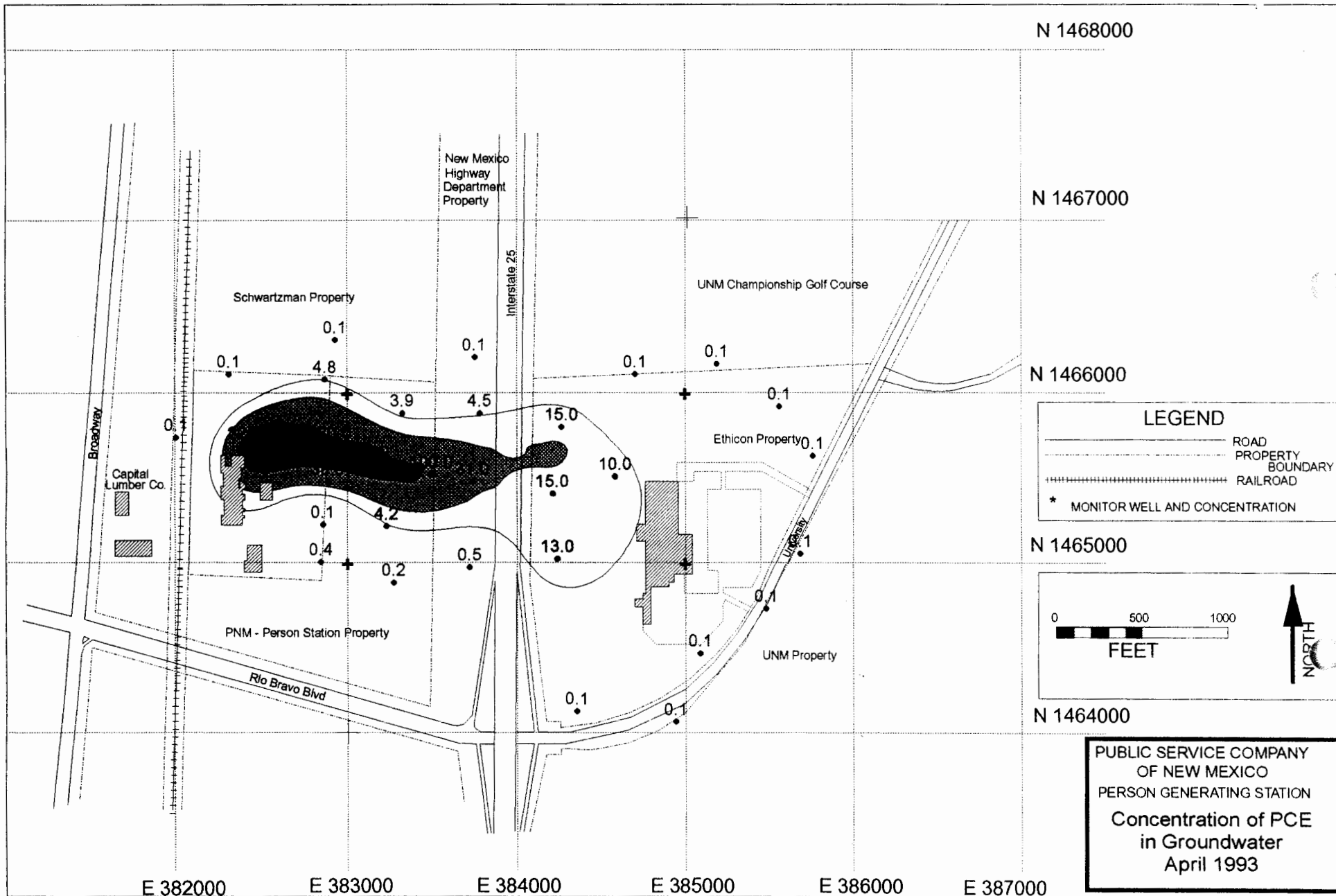

PUBLIC SERVICE COMPANY
OF NEW MEXICO
PERSON GENERATING STATION
**Concentration of PCE
in Groundwater
April 1993**

Concentration Key:

> 200 ppb

100 to 200 ppb

20 to 100 ppb

5 to 20 ppb

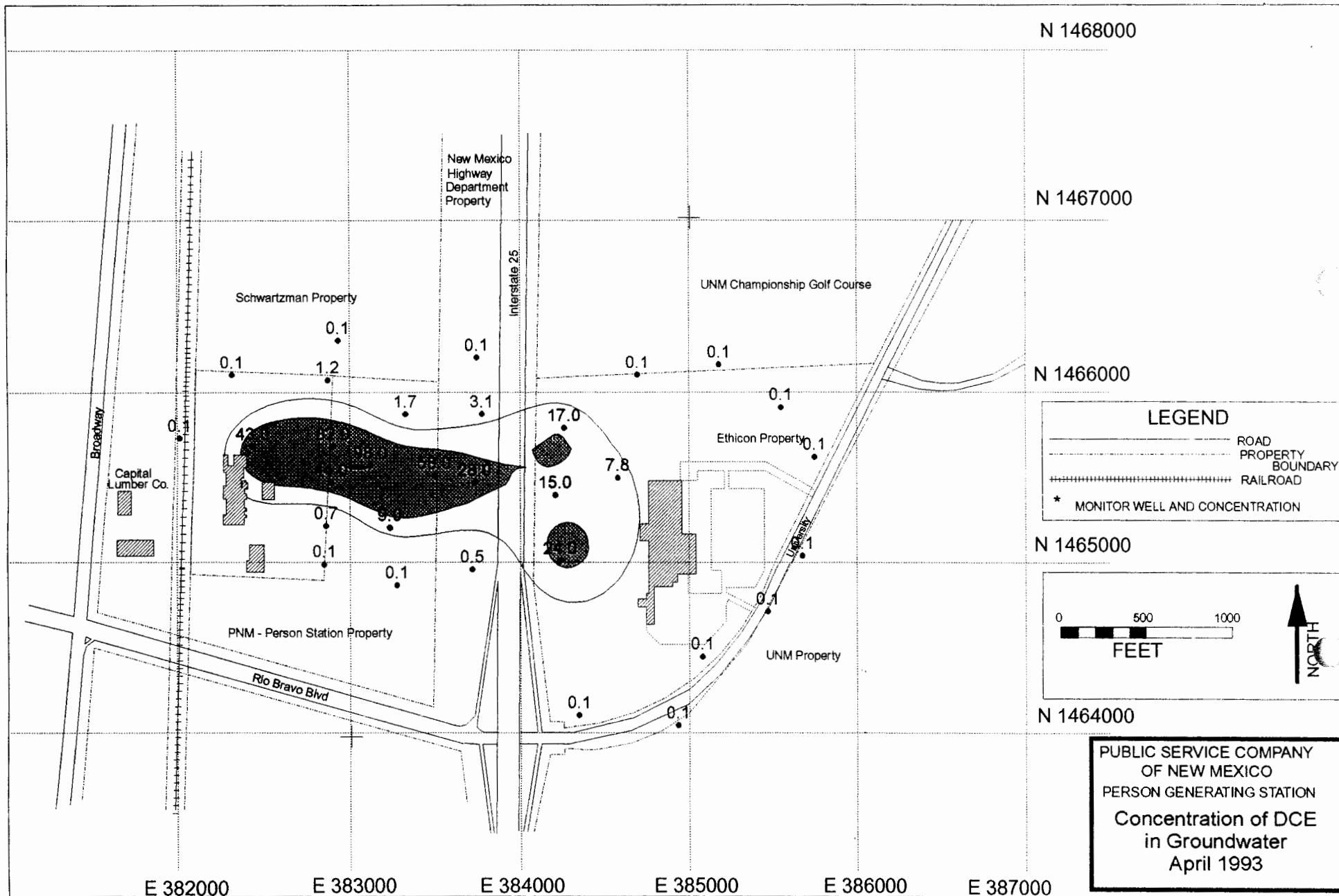

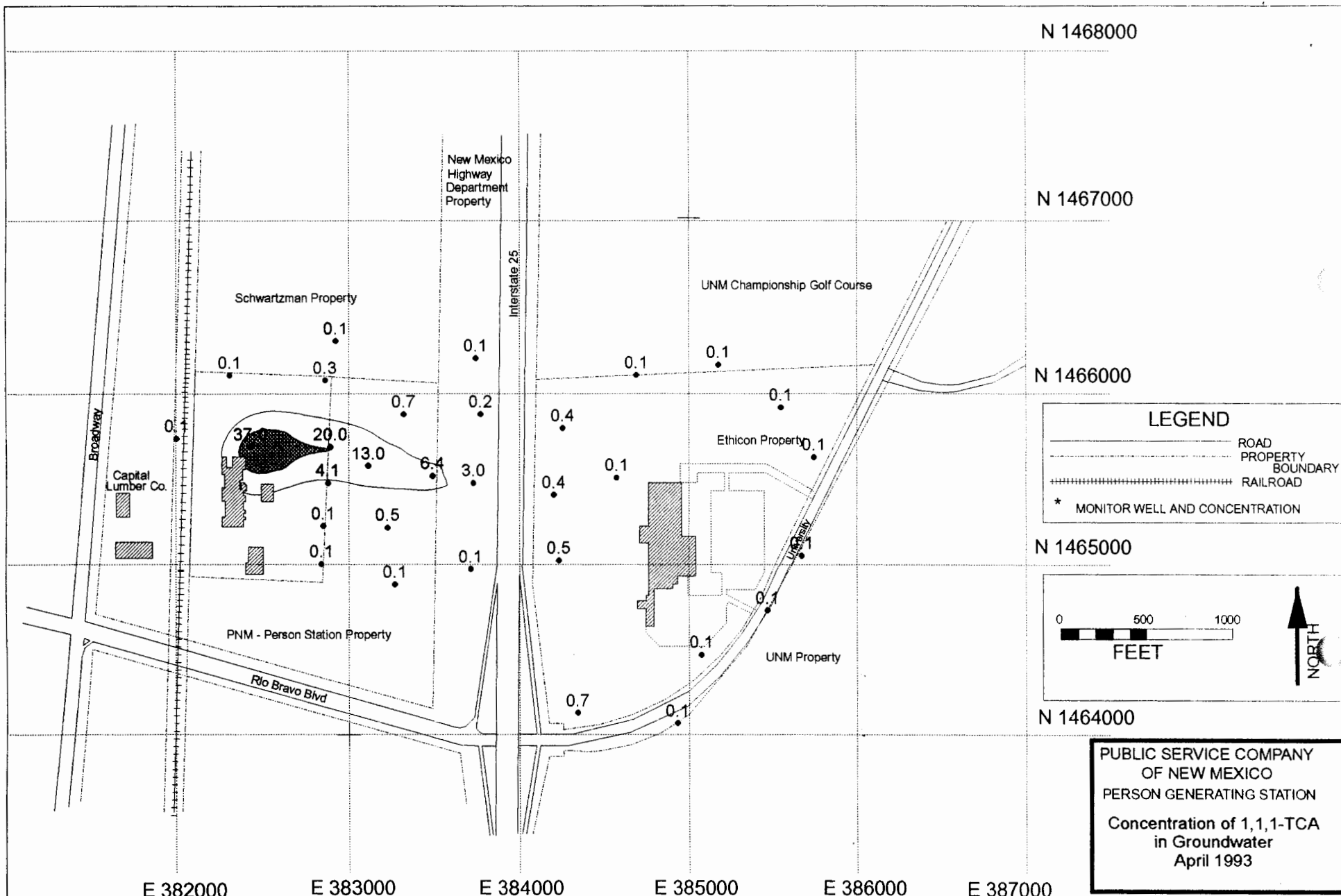

**PUBLIC SERVICE COMPANY
OF NEW MEXICO
PERSON GENERATING STATION
Concentration of DCE
in Groundwater
April 1993**

Concentration Key: > 200 ppb 100 to 200 ppb 20 to 100 ppb 5 to 20 ppb



Concentration Key:

 > 200 ppb

 100 to 200 ppb

 20 to 100 ppb

 5 to 20 ppb

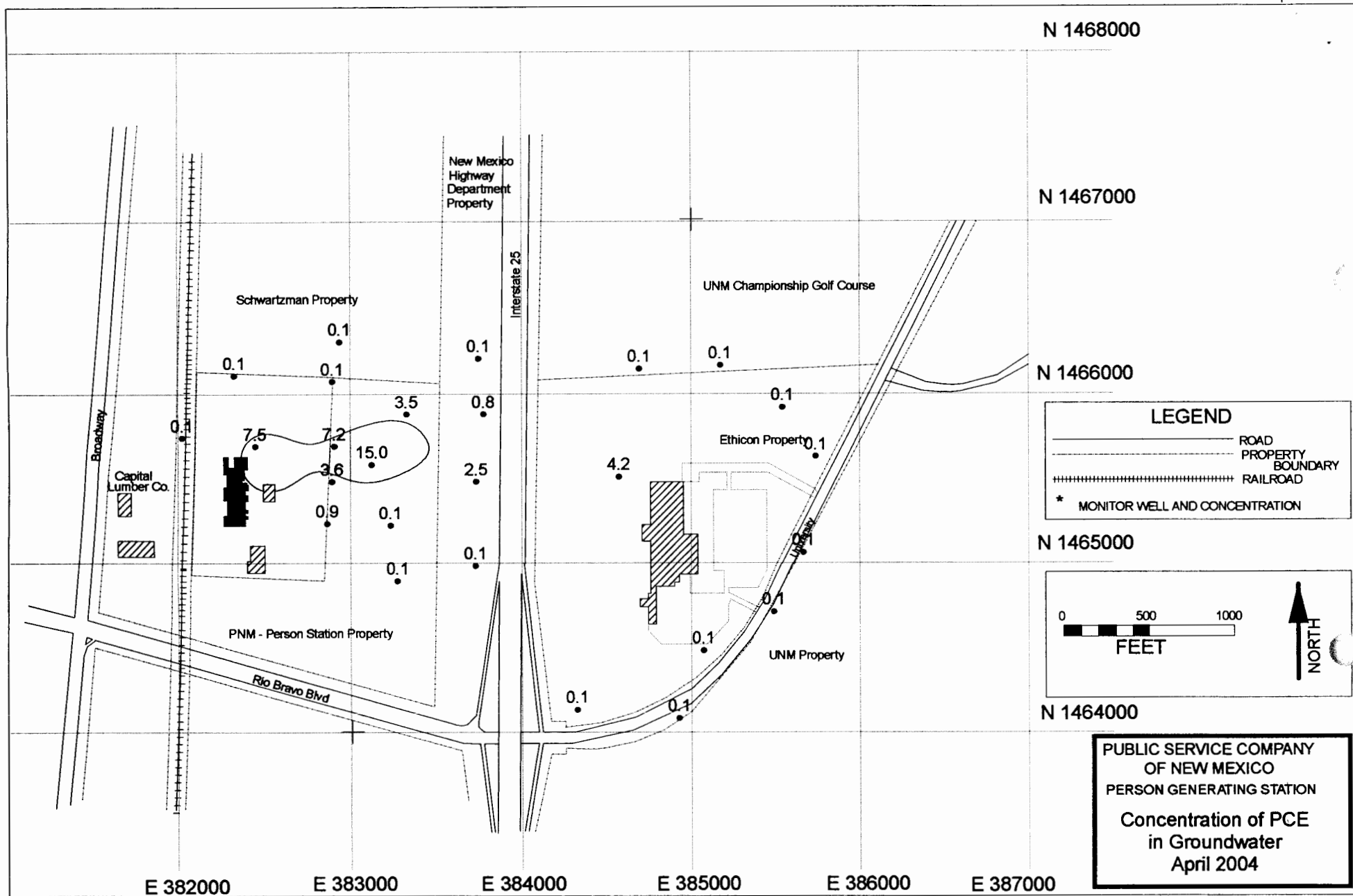

N 1468000

N 1467000

N 1466000

N 1465000

N 1464000

E 382000 E 383000 E 384000 E 385000 E 386000 E 387000

LEGEND

- ROAD
- - - PROPERTY BOUNDARY
- ||||| RAILROAD
- * MONITOR WELL AND CONCENTRATION

0 500 1000
FEET

NORTH

**PUBLIC SERVICE COMPANY
 OF NEW MEXICO
 PERSON GENERATING STATION**

**Concentration of PCE
 in Groundwater
 April 2004**

Concentration Key: > 200 ppb 100 to 200 ppb 20 to 100 ppb 5 to 20 ppb

